

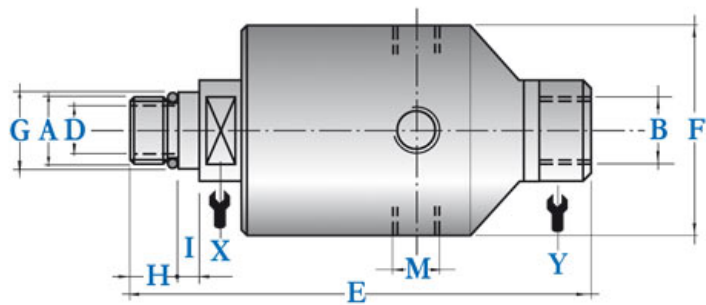

Istruzioni di montaggio  
Union installation  
Montageanweisungen  
Montaje de la junta

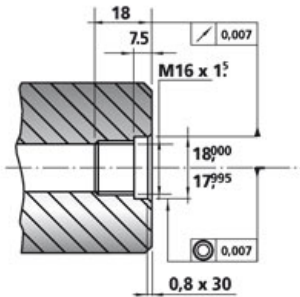

**1 PASSAGE, SIZES 1/4" AND 3/8"**

The unions for the models A and B have been designed for machine tool spindles rotating at high speed with fluid passing through or dry when needed. The seals, balanced and microlapped, remain always closed without problems both with fluid passing through (wet run) or without fluid (dry run).

**Transatlantic Connection Product Line**

Machine Tool Gauges, Tool Changer Alignment, Runout Test Arbors, Clamping Systems, Automatic Tool Holder Grippers, Tool Clamping Components, Pallet Clamping, Cooling and Filtering Systems, Tool Changer Systems, Springs, Brushes, Actuators and Motors, Couplings and Gears, ANY Machine Replacement or Spare Part

